

Recommended Collimators for ProLight **Hornet** Series



Features

- High efficiency
- Works with ProLight Hornet PC8N series
- Available in spot, medium, wide , frosted spot and oval lenses

Typical Applications

- Entertainment lighting
- Stage architectural lighting
- Washer and decorative lighting

September 2009 V1.0

Introduction of ProLight Hornet series

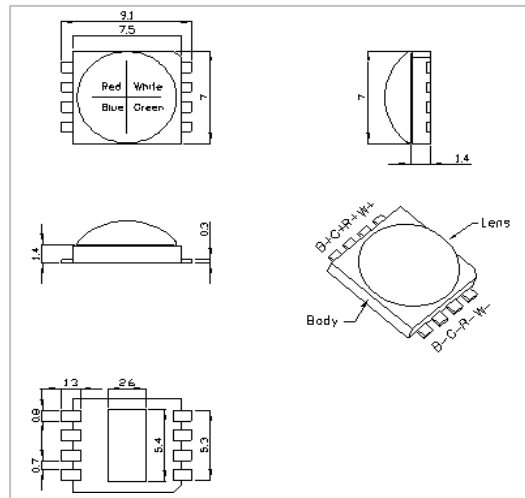

Mechanical Dimensions

Features

- RGBW Multi-color in one package
- Many collimators & reflectors are available
- Patent free
- Best thermal material solution of the world
- Best Moisture Sensitivity
- RoHS compliant

Recommended Collimators of Companies



<http://www.khatod.com/jsp/index.jsp>







<http://www.lumidrives.com/>

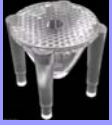

<http://www.lednlight.com>

Recommended Collimators List

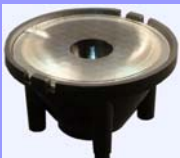
Single Lenses					
Series	Part Number	Lenses ϕ	Height	*Angle	
	PL1246	PL124625	24.62mm	14.40mm	25
		PL124640			40
	PL1243	PL124325LSD	26.80mm	20.85mm	25
		PL124340			40
	PL1244	PL124425LSD	35.00mm	21.60mm	25
		PL124440			40
	KEPL1241	PL124110_LUX	34.50mm	19.09mm	12
		PL124135_LUX			35
	PL1245	PL124510	34.41mm	18.91mm	12
		PL124520			20
		PL124525			25
		PL124540			35
	KEPL1133	KEPL113310D	38.10mm	20.76mm	12
		KEPL113320D			20
		KEPL113325D			25
		KEPL113335D			35

*The angle ($2\theta_{0.5}$) is the full angle measured where the luminous intensity is 50% of the peak value.

Recommended Collimators List



<http://www.lumidives.com/>

Single Lenses					
Series	Part Number	Lenses ϕ	Height	Angle	
	EVA	Eva-D	35mm	16.4mm	16
	EVA	Eva-M	35mm	16.4mm	22
	EVA	Eva-W	35mm	16.4mm	36.4
	LM1	LM1-D	20mm	12.5mm	20
	LM1	LM1-M	20mm	12.5mm	25
	LM1	LM1-REC	20mm	12.5mm	38 X 24
Single reflectors					
Series	Part Number	Lenses ϕ	Height	Angle	
	BOOM	BOOM-MC-S	22.2mm	13.54mm	20
	BOOM	BOOM-MC-M	22.2mm	13.54mm	38
	BOOM	BOOM-MC-W	22.2mm	13.54mm	48

Recommended Collimators List



<http://www.lednlight.com>

Single Lenses					
Series	Part Number	Lenses ϕ	Height	Angle	
	LL	LL10	16mm	8.6mm	29.5
	LL	LL17	16mm	8.6mm	27.6
	LL	LL25	16mm	8.6mm	30.4
	LL	LL9.16	16mm	8.6mm	28.8 X 38.4